

SB-5510

4x2 Scart Routing Switcher

SCART AUDIO SWITCHER

Input : 4x Scart
Output : 2x Scart



DIAGRAM TYPICAL

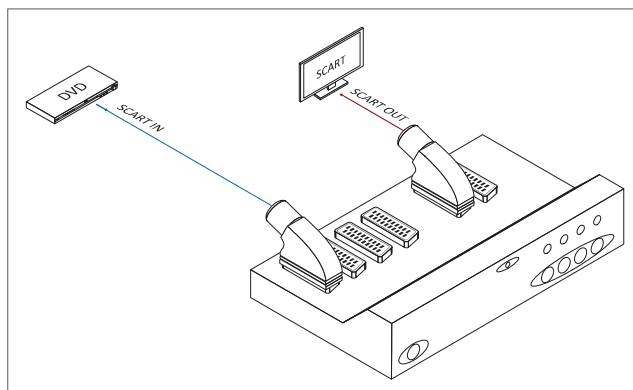

FEATURES

- Support SCART 4 inputs To 2 outputs routing switcher
- Input: 4x SCART (RGB, S-Video, Composite Video and Stereo Audio)
Output: 2x SCART (RGB, S-Video, Composite Video and Stereo Audio)
- SCART group input/output signals included
 - RGB
 - S-Video (Y/C)
 - Composite Video
 - Audio: Stereo Audio (AR, AL)
- Refresh: for HDTV 480i, 480p, 576p, 720p, 1080i, 1080p
- Control by IR remote and direct selection by front panel express buttons
- Inputs status with LED display read out via front panel
- Support ON/OFF power switch on front panel

SPECIFICATIONS

Type of Switcher	4 in To 2 out SCART Routing Switcher
Type of Signal	SCART (RGB, S-Video, Composite Video and Stereo Audio)
Video Bandwidth	110 MHz, -3dB (G=+2)
High Speed and fast settling	5V
IR Frequency	38KHz
Low Power	4.4 mA/Amplifier
Scan Rates Accepted	50Hz or 60Hz
Monitor screen	Auto Scan 16:9 or 4:3
Lower power consumed	consumed full load under 650/400Ma
Controls	IR remote controller, front pushbuttons with LED readout
Safety approvals	CE, FCC
Dimension (WxDxH)	9.37" x 6.02" x 1.73" (238mm x 153mm x 44mm)
Weight	0.9 kg / 1.98 lb
Power Supply	DC 12V, @1A (World Wide Universal AC 100~240V 50/60Hz)

SB-5520

4x2 Scart Matrix Switcher

SCART AUDIO MATRIX

Input : 4x Scart
Output : 2x Scart



DIAGRAM TYPICAL

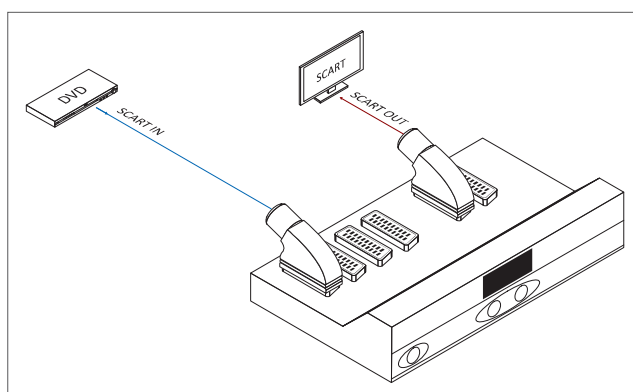

FEATURES

- Support SCART 4 inputs To 2 outputs matrix switcher
- Inputs : 4x SCART (RGB, S-Video, Composite Video and Stereo Audio)
Outputs : 2x SCART (RGB, S-Video, Composite Video and Stereo Audio)
- SCART Group input/output Signals included
 - RGB
 - S-Video (Y/C)
 - Composite Video
 - Audio: Stereo Audio (AR, AL)
- Refresh: for HDTV 480i, 480p, 576p, 720p, 1080i, 1080p
- Control By IR remote and direct selection by front panel express buttons
- Inputs status with LED display read Out via front Panel
- Support ON/OFF power switch on front panel

SPECIFICATIONS

Type of Switcher	4 in To 2 out SCART Matrix Switcher
Type of Signal	SCART (RGB, S-Video, Composite Video and Stereo Audio)
Video Bandwidth	110 MHz, -3dB (G=+2)
High Speed and fast settling	on 5V
IR Frequency	38KHz
Low Power	4.4 mA/Amplifier
Scan Rates Accepted	50Hz or 60Hz
Monitor screen	Auto Scan 16:9 or 4:3
Lower power consumed	consumed full load under 650/400Ma
Controls	IR remote controller, front pushbuttons with LED readout
Safety approvals	CE, FCC
Dimension (WxDxH)	9.37" x 6.02" x 1.73" (238mm x 153mm x 44mm)
Weight	0.9 kg / 1.98 lb
Power Supply	DC 12V, @1A (World Wide Universal AC 100~240V 50/60Hz)